



Angle Grinder

GA5080R 125 mm (5")

Pengisar Sudut 角向磨光机



PRODUCT
DETAILS
Models and specs
may vary by country

Continuous
Rating Input
Input Kuasa Berterusan 耗电量
1,400 w

GA5080R
with
Anti-restart
function

Just One Click

Hanya Satu Klik 一键式安装和拆卸砂轮片

PULL

XLOCK

Quick and Easy Wheel Change System

Sistem penggantian cakera pantas dan mudah

快轻松速更换砂轮片功能

Pull & Release

Snap-in in a second

RELEASE

PUSH

CLICK



Quick and Easy Wheel Change System

Sistem penggantian cakera pantas dan mudah 快轻松速更换砂轮片功能



Just one click to attach the accessories
easy removal just simply pull the lever

Hanya dengan satu sentuhan cakera dipasang dan dikeluarkan dengan mudah 只需轻轻一按即可轻松装卸砂轮片



No downtime

of installing and removing the accessories. Improve your work efficiency and work environment

Meningkatkan kecekapan kerja dengan tanpa risau tentang mengambil masa untuk cakera dipasang dan dikeluarkan 无需担心安装和拆卸砂轮片耗时而提高工作效率

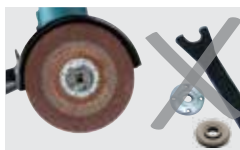

No tool required

X-LOCK mechanism ensures that the accessory is properly mounted to the tool even without nut, flange, and spanner

Mekanisme X-LOCK memastikan bahawa cakera dipasang dengan betul tanpa sepana X-LOCK 确保无需扳手即可正确安装砂轮片

Wheel release lever

Tuas pelepas cakera
砂轮片释放杆



Slide Switch

Suis slaid
滑动开关

Function of LED light

Lampu LED 指示灯



Solid Green indicates that the tool is ready to work

Lampu hijau yang stabil menunjukkan bahawa alat sedia untuk berfungsi 稳定的绿灯表示工具已准备好运行



Anti-restart function prevents accidental startup

Even if plugged in with the switch "ON", the tool does not start with a blinking red light for visual warning

Fungsi anti-restart mencegah permulaan yang tidak disengajakan, walaupun terpasang dengan suis "ON", alat ini tidak boleh dimulakan dengan lampu merah yang berkedip untuk peringatan visual 防重启功能防止意外启动 即使在开关 "ON" 的情况下, 该工具也无法启动, 以闪烁的红灯作为视觉提醒

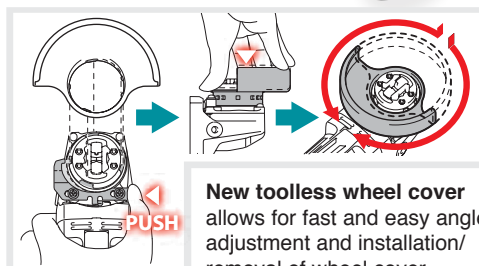

New toolless wheel cover allows for fast and easy angle adjustment and installation/removal of wheel cover

Penutup cakera tanpa alat memudahkan pelarasan sudut, pemasangan dan penanggalan penutup cakera 新型免工具轮罩可实现快速简便的角度调整以及砂轮罩的安装/拆卸



No over-tightening

X-LOCK accessories are firmly attached and cannot be mounted incorrectly

Tidak perlu risau tentang pengetatan terlebih atau terkurang, X-LOCK memastikan cakera pengisar dipasang dengan kuat dan betul X-LOCK 确保砂轮片牢固安装, 无需担心螺母拧得过紧或拧紧不足



No scratching workpiece by nuts even when flat grinding

Tidak perlu risau tentang geseran nat semasa pengisaran rata 即使进行平面研磨也不必担心螺母摩擦或磨损, 使用无忧

Accessories (Optional)

Aksesori pilihan 可附加选购配件

Dust Collection wheel guard

for Diamond wheel
Part No. 191G05-4



Anti-vibration grip

Part No. 194514-0



Wheel cover

for abrasive cut-off wheel
Part No. 162708-5



125 mm X-LOCK wheels

125mm X-LOCK accessories are compatible with conventional angle grinders

Grinding Wheel/ Metal
Part No. E-00393(EN)

Thin Cut-off Wheel (Flat)
Part No. E-00418(EN)

Grinding Wheel/ Stainless
Part No. E-00402(EN)

Diamond Wheel/ Concrete
Part No. E-02076



GA5080R

318

Continuous Rating Input Input Kuasa Berterusan 耗电量	1,400W
Wheel Diameter Diameter Roda 轮片直径	125 mm (5")
Max Wheel Thickness Ketebalan Roda Maksimum 最大轮片厚度	6 mm (1/4")
Max Cutting Depth Kedalaman Pemotongan Maksimum 最大切割深度	31 mm (1-1/4")
No Load Speed (RPM) Kelajuan Tanpa Beban 回转数	12,000
Dimensions (L x W x H) Dimensi 体积	309 x 141 x 113 mm (12-1/8 x 5-9/16 x 4-7/16")
Net Weight Berat Bersih 净重	2.5 - 3.6 kg (5.5 - 7.9 lbs.)
Power Supply Cord Kabel Wayar 电源线	2.5 m (8.2 ft)
Standard Equipment Aksesori standard 标准附件	
Depressed Center Wheel (E-00402), Side Grip, Wheel Cover	

Like us on Facebook
MAKITA MALAYSIA

* Continuous Usage Time/ Work Amount: Actual performance may vary based on application. Items of standard equipment and specifications may vary by country or area. The weight and dimensions may differ depending on the attachment(s), including the battery cartridge. All pictures shown are for illustration purposes only. In the event of differences arising between the English, Bahasa Malaysia and Chinese versions, the English version shall prevail. Masa Penggunaan Berterusan/ Jumlah Kerja: Prestasi sebenar mungkin berbeza mengikut aplikasi. Spesifikasi standard mungkin berbeza mengikut negara. Berat bersih dan dimensi berbeza bergantung pada jenis bateri yang digunakan. Imej yang ditunjukkan hanya untuk tujuan ilustrasi sahaja. Jika terdapat perbezaan antara bahasa, maka maklumat versi Bahasa Inggeris harus digunakan. 连续使用时间/工作量: 实际表现可能因应用情况而异。注: 规格可能因销往国家之不同而异。重量与尺寸因附件(包括电池组)而异。图片仅供参考。如果内容有任何差异或不一致, 概以英文版本为准。

12 MONTHS WARRANTY

Makita Power Tools (Malaysia) Sdn. Bhd. Co. Registration No.: 201301001778 (1031615-M)

HQ & Service Centre

总部及服务与展示中心
Lot 824, Jalan Subang 5, Subang Industrial Area,
47500 Subang Jaya, Selangor.
Tel: 03-8023 0824 (General) | Fax: 03-8022 1448
03-8022 1443 (Service)

Johor (Johor Bahru) Service Centre

柔佛(新山)服务与展示中心
No.12 & 14, Jalan Rosmerah 2/9,
Taman Johor Jaya,
81100 Johor Bahru, Johor.
Tel: 07-364 9406 | Fax: 07-364 9407

Sarawak (Kuching) Service Centre

砂拉越(古晋)服务与展示中心
Lot 1227, Lorong Demak Indah 2A,
Demak Laut Industrial Area, Phase 2A,
93050 Kuching, Sarawak.
Tel: 082-496 800 | Fax: 082-496 900

Sabah (Kota Kinabalu) Service Centre

沙巴(亚庇)服务与展示中心
Lot 19, Jalan Buah Duku,
Kolombong Light Industrial Estate, Off Kolombong,
Kolombong Zone 1, 88450 Inanam, Kota Kinabalu, Sabah.
Tel: 088-388 278 | Fax: 088-388 279



www.makita.my
✉ makita@makita.my